

Brody

From: DolanPond@aol.com
Sent: Tuesday, February 12, 2008 2:46 PM
To: undisclosed-recipients:
Subject: Newton Conservators e-Newsletter - February 12, 2008



*Working to preserve open space in Newton for 47
years!*

The Newton Conservators **e-Newsletter**

February 12, 2008

www.newtonconservators.org

Newton Conservators e-Newsletter

Welcome to another edition of our sporadical e-Newsletter, whose purpose is to provide some timely updates on open space and nature related news in Newton. The printed edition of the news (published about 4 times a year) is sent by mail/email to the membership of the Newton Conservators. PDF copies are available: <http://www.newtonconservators.org/newsletter.htm>. This Newton Conservators e-Newsletter replaces our previous Newton Conservators Nature Notes. Our format is a little different and may include some photos (which will be kept somewhat low resolution) but should be fairly easy to print out. If your email is set to receive text only, there may be some settings in your email program to allow html formatted email. If you have difficulty please let us know. If you no longer wish to receive this email newsletter, please let us know by replying to this email. We welcome articles and news notes that might be of interest to our readers. If you have any suggestions, email Ted Kuklinski (e-Newsletter editor) at dolanpond@aol.com or calling 617-969-6222.

This issue is really chock full of news, events, and updates! Take note of a special hearing this evening (Thursday Feb 12) at 7 pm of the Community Preservation Committee on a revised proposal for 230 Lake Avenue (on Crystal Lake) which takes place in the War Memorial Auditorium at City Hall.

In This Issue:

- **Crystal Lake - 230 Lake Avenue Update**
 - **Action - What you can do**
 - **Community Preservation Notes**
 - **Shop at Bloomingdale's on February 27th and**
 - **Help the Newton Conservators at the Same Time!**
 - **February Environmental Show on NewTV's Blue Channel**
Wild Edible Plants with Naturalist Russ Cohen
 - **Newton Conservators Spring Lecture**
North of Quabbin - Lessons in Land Protection
Wednesday, March 19, 7 pm - Newton Free Library
Allen Young - Journalist and Land Protection Advocate
 - **Christmas Bird Count Results - December 23, 2007**
 - **Birding Notes: Dovekie Lands in Newtonville**
 - **Future Vision for Albemarle Road and Cheesecake Brook**
 - **Notes from the Newton Angino Community Farm**
 - **Green Decade Notes**
 - **Newton History Museum Notes**
 - **NewtonSERVES - Sunday, April 13, 2008**
 - **New Off Leash Ordinance Passed - Volunteers Needed!**
 - **Mission - Newton Conservators**
 - **Newton Conservators Membership Form**
-

Crystal Lake - 230 Lake Ave Update

There has been a lot of recent attention and controversy surrounding the possible CPA acquisition of the property at 230 Lake Avenue which is on Crystal Lake. 230 Lake Avenue is between Levingston Cove and the former Hannon property (which is next to the Crystal Lake swimming area and was recently taken by eminent domain). It fortuitously came on the market and would provide a continuous city owned stretch of Crystal Lake shoreline from the bathhouse to Levingston Cove - with wonderful open space potential.

Our last newsletter appeared prior to the meeting of the aldermanic Finance Committee. The original proposal was to divide the acquisition into a \$1.4 M CPA portion and a \$550K house portion to be bonded by the city. The Finance Committee did not recommend the proposal and it was to be voted upon by the full board. Requests to delay the vote were put forward in order to do some restructuring of the proposal, to have further discussions with the owner, and to allow interested parties to weigh in.

In a final effort to complete a 'deal' that works for all, the Crystal Lake Conservancy group has submitted a request for CPC reconsideration of the 230 Lake Ave. acquisition. The request revises the proposal in several ways in order to address various concerns raised and eliminate the

need for funding the purchase with city general funds and would provide the most valuable amenities to the public along with options to recoup a significant part of this investment by:

- Funding the entire purchase with CPC money at a cost not greater than appraised value
- Creating a permanent waterfront easement to connect all public parcels
- Subdividing the parcel to allow for the house to be leased or sold to an appropriate user- with proceeds to return to CPC fund.
- Establishing a conservation and historic restriction on the property and home in order to protect it from wholesale modifications or destruction.
- Allowing a resident caretaker to occupy and maintain the house until its future is settled.

This proposal would address the major reservations for those who understand the purpose and value of this acquisition, but have not been able to support it due to fiscal concerns and reservations about the disposition and future of the house. The very patient owner, Mrs. Sciegeeny, has delayed, but will need to put the property back on open market with no positive indications from the city.

If the community does not gain ownership of this site, a new private owner might be free to build a structure that is more than twice the size of the present home. This may be the final opportunity for this proposition.

As reported in our last issue, the entire CPC was not fully convinced on this project.

Please attend this Special **CPC PUBLIC HEARING - TUESDAY, 12 February, 7 PM in the WAR MEMORIAL AUDITORIUM at City Hall.** A public showing of support is always very important. If you cannot attend, consider sending an email to the CPC via CPA planner Alice Ingerson at aingerson@newtonma.gov or perhaps leaving a message at 617.796.1144.

The Newton Conservators have come out to officially support this acquisition and recently have agreed to a mechanism of holding funds for a Crystal Lake friends group. Here is the text of recent Newton Conservators support for the project which was published as a letter in the Newton Tab.

January 10, 2008

Subject: Purchase of property at 230 Lake Street by the City

We support the purchase by the City of Newton of the house at 230 Lake Avenue in Newton Centre with funding support by the Community Preservation Committee. Acquiring this property would set aside a contiguous section of City owned property from the swimming area to Levingston Cove. This is a wonderful opportunity to provide for future open space improvements in terms of future activities. We applaud the efforts of Newton Highlands Neighborhood Area Council and the Mayor for making an application under the Community Preservation Act to obtain this essential piece of property in the restructuring of Crystal lake.

The Community Preservation Committee members have judiciously selected numerous properties that provide open space and recreational areas for Newton residents. Addition of this property would set the stage for an eventual belt of lakefront land that could be used for open space viewing along with increased access for lake-based activities. It is these types of decisions that maintain Newton's commitment to open spaces in all parts of the City.

This land purchase will serve the Newton community for years to come with a general Crystal Lake open space park for all to enjoy.

Sincerely yours,

*William Hagar
President, Newton Conservators*

The Newton Conservators, in their December board meeting, agreed to hold funds for the Crystal Lake Conservancy until such time as their official nonprofit status is established. As part of this proposal, we have also been asked to hold (and monitor) any conservation restrictions on this acquisition (a role we have fulfilled on other city parcels).

At our most recent board meeting (1/23/08), we had extensive discussion on the topic of the 230 Lake Avenue. As a concrete indication of our support for this project, I have been authorized to report to you that the board of the Newton Conservators met and voted unanimously that "**if money is needed beyond the CPA funding to acquire 230 Lake Avenue, we would be willing to donate a minimum of \$15, 000 if the plan for the property conforms to our mission statement*.**"

**(which promotes the protection and preservation of natural areas, including parks, park lands, playgrounds, forests and streams, which are open or may be converted to open spaces for the enjoyment and benefit of the people of Newton for scientific study, education, and recreation.)*

It is clear that there are many divergent opinions on this possible acquisition. Issues raised included whether to keep the house, what use it could have, whether more parking was needed, the fact that we have spent a lot in this area already, the question of long term maintenance, the need for a plan. In all this process, we owe a debt of gratitude to Mrs. Sciegenny, a woman who had good intentions in offering her property to city first knowing that it could be of benefit to the citizens of Newton as part of a larger park, but at the same time needing to sell off the property in a reasonable time frame to cover her care. Her patience so far in the process has been admirable.

Please check out the Crystal Lake Conservancy Community Participation and Fundraising plan at <http://blogs.townonline.com/newton/?p=17772> to find out more about the project. Hopefully you have seen some of the visions of what the property could become (e.g. one of the concept plans generated by Robert Fizek - certainly not definitive but it certainly whets the imagination).

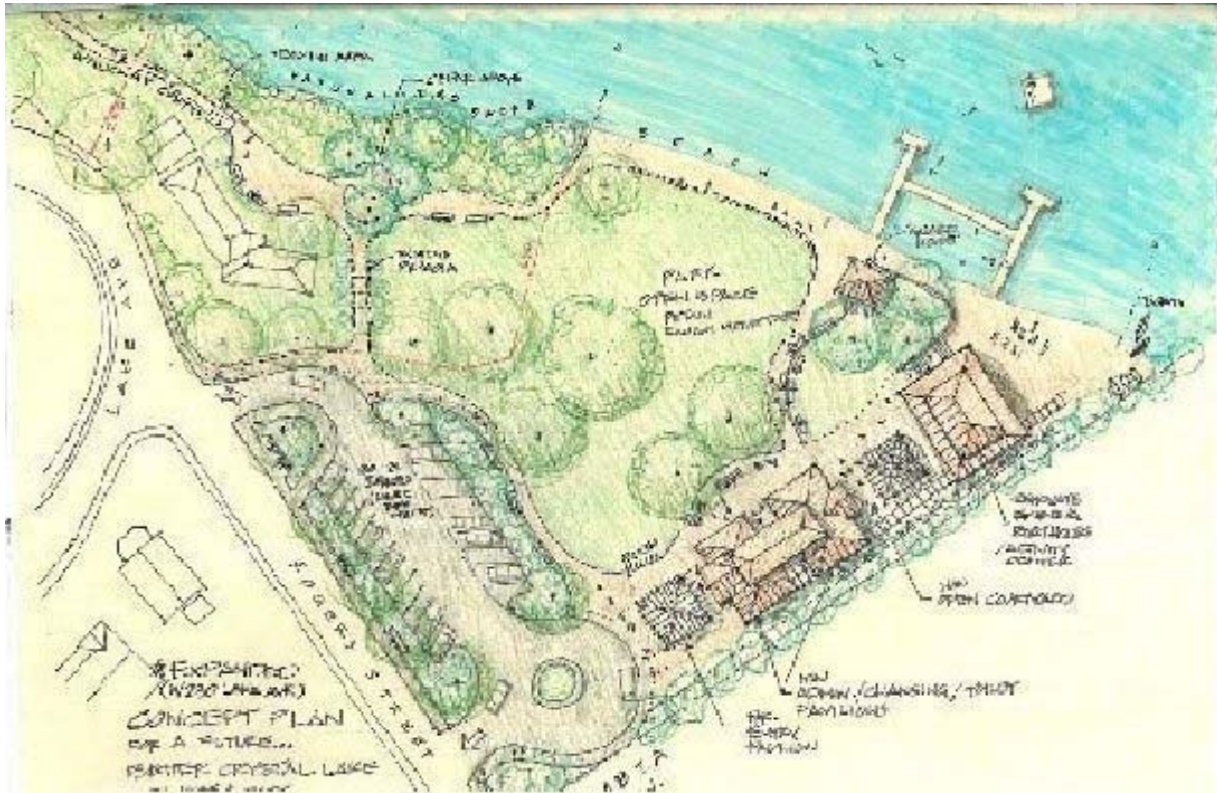

Here are the comments of Newton historic activist John Rodman on one of the Tab blogs, "This opportunity for the City should not be squandered, as have been so many real estate holdings de-accessioned due to short-sightedness. This is a chance to consolidate the city's lakeside properties with 100% state matching funds via the CPA, which was designed specifically to encourage and enable cities and towns to address the often and otherwise ignored 'non-essentials' of open space, historic preservation and affordable housing, all of which enhance the quality of life in our communities. Just looking at a map showing the two parcels the City owns on either side of the subject parcel demonstrates the long term wisdom of the proposed acquisition. Let's not have this deal become another 'one that got away'."



A view on Crystal Lake from the Levingston Cove to the bathhouse; 230 Lake Avenue is the house on the right.

Looking at an aerial view of the the 230 Lake Ave property in relation to the other pieces, one might call it the keystone of what could be a great park on a great pond! As was stated by someone at the Finance Committee meeting on this proposal, the "whole in this case is much greater than the sum of the parts". It opens up the possibility of usage of many sorts year round - not just a short swim season. The lake is about a lot more than just swimming. With the whole property, the park could be newly configured into something truly wonderful rather than merely

adequate. Already, the demolition of the Rogers Street house has made a tremendous difference in the feel of the area and it could be so much more!

Action - What you can do

If you have some opinions on this or other issues before Board of Aldermen, why not use the democratic process and let your elected officials know of your concerns? Contact information for the Board of Aldermen can be found on the city website at <http://www.ci.newton.ma.us/Aldermen/index.asp>. Check it out and get to know your aldermen!

Scott Lennon,	Ward 1 Ward Alderman,	617-584-5723,	sflennon@comcast.net
Carleton Merrill,	Ward 1 Alderman at Large,	617-244-2421,	(no email)
Allan Ciccone, Jr.,	Ward 1 Alderman at Large,	617-965-2690,	allancicconejr@comcast.net
Stephen Linsky,	Ward 2 Ward Alderman,	617-796-1701,	slinsky@newtonma.gov
Marcia Johnson,	Ward 2 Alderman at Large,	617-965-4920,	marcia@marciajohnson.org
Susan Albright,	Ward 2 Alderman at Large,	617-527-7108,	salbright@newtonma.gov
Anthony Salvucci,	Ward 3 Ward Alderman,	617-244-2509,	asalvucci@newtonma.gov
Ted Hess-Mahan,	Ward 3 Alderman at Large,	617-795-7220,	thessmahan@newtonma.gov
Greer Tan Swiston,	Ward 3 Alderman at Large,	617-308-7906,	aldermanswiston@gmail.com
Jay Harney,	Ward 4 Ward Alderman,	617-332-4283,	jayharney@rcn.com
Leonard Gentile,	Ward 4 Alderman at Large,	617-527-5446,	lennypmgi@aol.com
Amy Mah Sangiolo,	Ward 4 Alderman at Large,	617-969-0677,	sangiolo@rcn.com
William Brandel,	Ward 5 Ward Alderman,	617-332-0719,	bill@billbrandel.org
Paul Coletti,	Ward 5 Alderman at Large,	617-965-3654,	Nesi49@aol.com
Brian Yates,	Ward 5 Alderman at Large,	617-244-2601,	byates@newtonma.gov
George Mansfield,	Ward 6 Ward Alderman,	617-969-1479,	gmansfield@newtonma.gov
Victoria Danberg,	Ward 6 Alderman at Large,	617-969-1756,	vdanberg@aol.com
Kenneth Parker,	Ward 6 Alderman at Large,	617-965-3723,	ken@kenparker.org
Lisle Baker,	Ward 7 Ward Alderman,	617-566-3848,	AldermanBaker@comcast.net
Sydra Schnipper,	Ward 7 Alderman at Large,	617-965-2331,	Sydra_Schnipper@verizon.net
Verne Vance,	Ward 7 Alderman at Large,	617-232-5494,	vvance@rcn.com
Cheryl Lappin,	Ward 8 Ward Alderman,	617-796-1723,	Clappin@newtonma.gov
Mitch Fischman,	Ward 8 Alderman at Large,	617-964-2848,	mfischman@daylor.com
John Freedman,	Ward 8 Alderman at Large,	617-243-9509,	johnfreedman@comcast.net

The following is the email string for the Board of Alderman members (except for Alderman Merrill who does not list an email) plus the City Clerk. The is derived from the contact information on the city website at <http://www.ci.newton.ma.us/Aldermen/index.asp>

AldermanBaker@comcast.net, aldermanswiston@gmail.com, allancicconejr.comcast.net, asalvucci@newtonma.gov, bill@billbrandel.org, byates@newtonma.gov, Clappin@newtonma.gov, gmansfield@newtonma.gov, jayharney@rcn.com, johnfreedman@comcast.net, ken@kenparker.org, lennypmgi@aol.com, marcia@marciajohnson.org, mfischman@daylor.com, Nesi49@aol.com, sangiolo@rcn.com, salbright@newtonma.gov, sflennon@comcast.net, slinsky@newtonma.gov, Sydra_Schnipper@verizon.net, tedhess-mahan@rcn.com, Vdanberg@aol.com, vvance@rcn.com, dolson@newtonma.gov

Community Preservation Notes

FY08 CPA PROPOSALS are online here at www.ci.newton.ma.us/Planning/CPAC/08applications.html. The contact in the Planning Department for CPA is Alice Ingerson, Community Preservation Program Manager, 617.796.1144 or aingerson@newtonma.gov. You can check out the main city CPA website at www.ci.newton.ma.us/cpa/.

On Tuesday, February 12, 7 pm there will be a special CPC Public Hearing in the War Memorial Auditorium, City Hall To consider revised proposals for 230 LAKE AVENUE (open space & recreation land) and 29 COYNE ROAD (community housing). On Wednesday, February 27, 7 pm there will be the regular CPC meeting in City Hall Room 222 - a working session for FY08 PROPOSALS & FY09 ADMINISTRATIVE BUDGET. The tentative list of proposals to be discussed (not necessarily in this order) is the following: City Archives; Heritage Landscape Inventory; Newton Fire Department Headquarters Historic Doors; Newton History Museum Archives.

Shop at Bloomingdale's on February 27th and Help the Newton Conservators at the Same Time!

Wednesday, February 27, 2008, 10 AM -10 PM
The Shopping Benefit at Bloomingdale's in the Chestnut Hill Mall

Give a little . . . Get a lot! The Shopping Benefit is a Bloomingdale's celebration to benefit over 40 local charities and non-profit organizations, including the Newton Conservators. Enjoy a day of store-wide savings, special events, prizes, live entertainment, and much more. Purchasing a \$10 ticket benefits you and the Newton Conservators. Bloomingdale's is in the Chestnut Hill Mall, 225 Boylston Street (Route 9), Newton, MA 02467.

Benefits for you:

- * Save 15% on almost everything at both stores at the Chestnut Hill Mall
- * Spend over \$300 using your Bloomingdale's charge card and receive an extra 5% off (total of 20%)
- * Open a Bloomingdale's charge card on February 27 and take an extra 15% off all day long
- * If you are unable to attend the event on February 27, you can pre-select your purchases beginning Thursday, February 21. A Bloomingdale's Sales Associate will hold your purchases, along with your credit card number and Habitat for Humanity ticket, and charge your merchandise on February 27, the day of the event. You'll receive the discount and Habitat for Humanity will get credit for your ticket! Pick up your purchases at your earliest convenience - on or after February 27.

Benefits for the Newton Conservators:

- * \$10 ticket fee goes directly to the Newton Conservators (100% of ticket sale is tax deductible).
- * Turn in your ticket stub (with the Newton Conservators stamp on the back) at the door on the day of the event and Bloomingdale's will donate \$5 to the Newton Conservators.
- * If 70 people or more turn in their Newton Conservators ticket stubs at Bloomingdale's on February 27, then the NEWton Conservators will share in the proceeds collected at the door!

You can donate when you renew your membership or mail a check to The Newton Conservators, Inc., PO Box 590011, Newton Centre, MA 02459. Note "The Shopping Benefit" on the envelope and we'll send you the tickets. If you would like to purchase some tickets or get some to sell to your friends, let us know (dolanpond@aol.com or call Ted at 617-969-6222).

February Environmental Show on NewTV's Blue Channel

Wild Edible Plants with Naturalist Russ Cohen

In this month's Environmental Show on NewTV, learn to eat your way through the woods with the help of professional environmentalist and wild foods enthusiast Russ Cohen. His lecture slide presentation on the Wild Edible Plants of New England, was originally presented as the Newton Conservators Fall lecture (September 20, 2007) at the Newton Free Library. Russ Cohen is the author of "**Wild Plants I Have Known ... and Eaten**" published by the Essex County Greenbelt Association. Russ provides a practical guide to foraging in the forest for wild edibles, covering seasonal availability, methods of preparation, nutritional value, and guidelines for ecologically responsible and safe foraging. Learn how to put such well known invasive plants as Japanese knotweed or garlic mustard to culinary use - strawberry-knotweed pie anyone? Learn more about the speaker at <http://users.rcn.com/eatwild/bio.htm>.

Part 1 of the presentation will be broadcast in February on the Blue Channel (Comcast Channel 10, RCN Channel 15) on Saturdays 10 a.m., Mondays 3 p.m, Tuesdays 1:30 p.m. & 11:30 p.m., Wednesdays 11:30 a.m. and Thursdays noon, 4 p.m. & 7:30 p.m. Part 2 will be shown in April.

The monthly Environment Show on NewTV is now in its 4th year. The show is produced by a partnership of the Green Decade (www.greendecade.org) and the Newton Conservators (www.newtonconservators.org), with each organization responsible for the show on alternating months. Past shows by both the Newton Conservators and the Green Decade Coalition can be viewed on the web at <http://www.greendecade.org/environmentTV.html>.

Newton Conservators Spring Lecture

North of Quabbin - Lessons in Land Protection

Wednesday, March 19, 7 pm - Newton Free Library

Allen Young - Journalist and Land Protection Advocate

Newton's pure water originates in the Quabbin Reservoir in central Massachusetts, yet the area around Quabbin is unfamiliar to most residents except for perhaps birding and fishing enthusiasts. Allen Young, land protection advocate and author of "**North of Quabbin Revisited: A Guide to Nine Towns North of the Quabbin Reservoir**" will be the featured speaker for the Newton Conservators Spring Lecture. He will talk about the unique nine-town area known as the North Quabbin as well as the Quabbin Reservoir itself, and about exciting and sometimes difficult land protection and recreational opportunities there. It has relevance for the people of Newton who may appreciate the concept of saving the rural parts of the Commonwealth that are under so much development pressure.

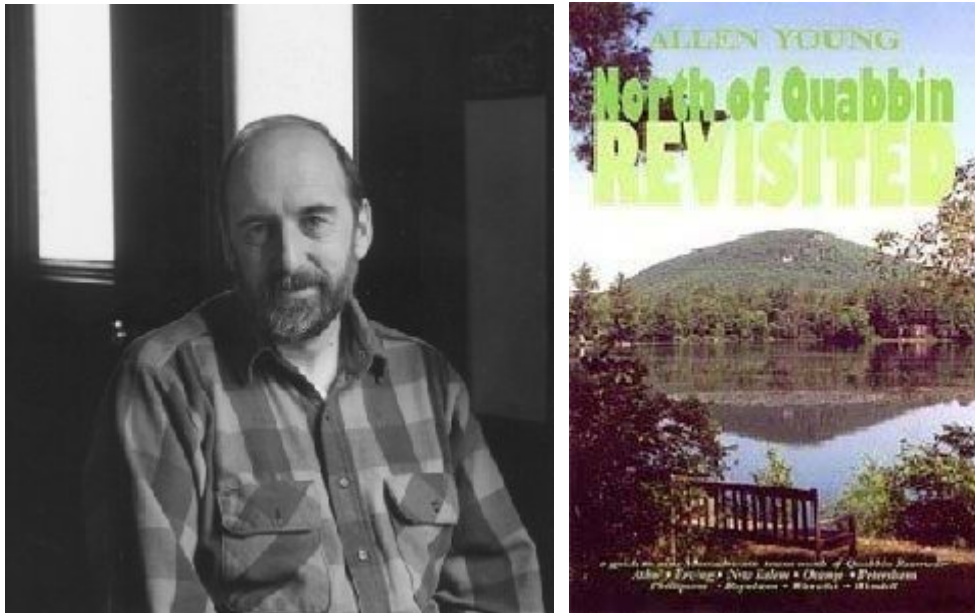

Allen Young, journalist and author of 13 books, has lived for nearly 35 years in the North Quabbin Region, one of the most rural areas of Massachusetts. He settled to the town of Royalston (population about 1,000) in 1973 as part of the "back-to-the-land" movement, taking a job as reporter for the Athol Daily News, later working as the community relations director for the Athol Memorial Hospital. His most recent book is a collection of articles entitled "**Make Hay While the Sun Shines: Farms, Forests and People of the North Quabbin.**" Now retired, he cultivates a large vegetable and flower garden, and volunteers for the Mount Grace Land Conservation Trust, dedicated to protecting farms and forests in a 23-town area. He holds a masters degree from the Columbia University Graduate School of Journalism and was even briefly a reporter for the Washington Post. In 2004, he received the Writing and Society Award from the University of Massachusetts English Department honoring a distinguished career of commitment to the work of writing in the world

This free event takes place on Wednesday, March 19, 7 pm, at the Druker Auditorium at the Newton Free Library, 330 Homer Street in Newton Centre and is cosponsored by the Newton Free Library (www.newtonfreelibrary.net, 617-796-1360). For more information, contact Ted Kuklinski, 617-969-6222, dolanpond@aol.com, or visit www.newtonconservators.org/lectures.htm.

Christmas Bird Count Results - December 23, 2007

by Cris Criscitiello

Thanks to all who were able to help again with our Annual Christmas count. Here is the data for our 2007 Newton count together with three previous years listed for comparison. Names in bold type represent species not often seen in this area during late December. This year's count was postponed from the previous Sunday due to a severe snowstorm. Some points of interest from the count are the following:

- 1). The good numbers of Hooded Mergansers in the past two years, most of them seen this year on the Charles River since the lakes were frozen.
- 2) The absence of Fish Crows
- 3). Only a single Red-breasted Nuthatch in the past four years They have been visiting feeders at two sites, but we didn't see them on Dec 23.
- 4). The first Bohemian Waxwings ever recorded, not only in Newton, but in the entire Boston Count area! (thanks to Sam Jaffe),
- 5). Wild Turkeys, known to be present during the winter in several places in the city, actually turned up for the first time during this count.
- 6). No Screech Owls seen or heard this year. We visited ten of the sites where we've encountered them previously with no luck. Had the heavy snow fall earlier in the month, followed by a cover of ice, deprived them of their usual sources of food?

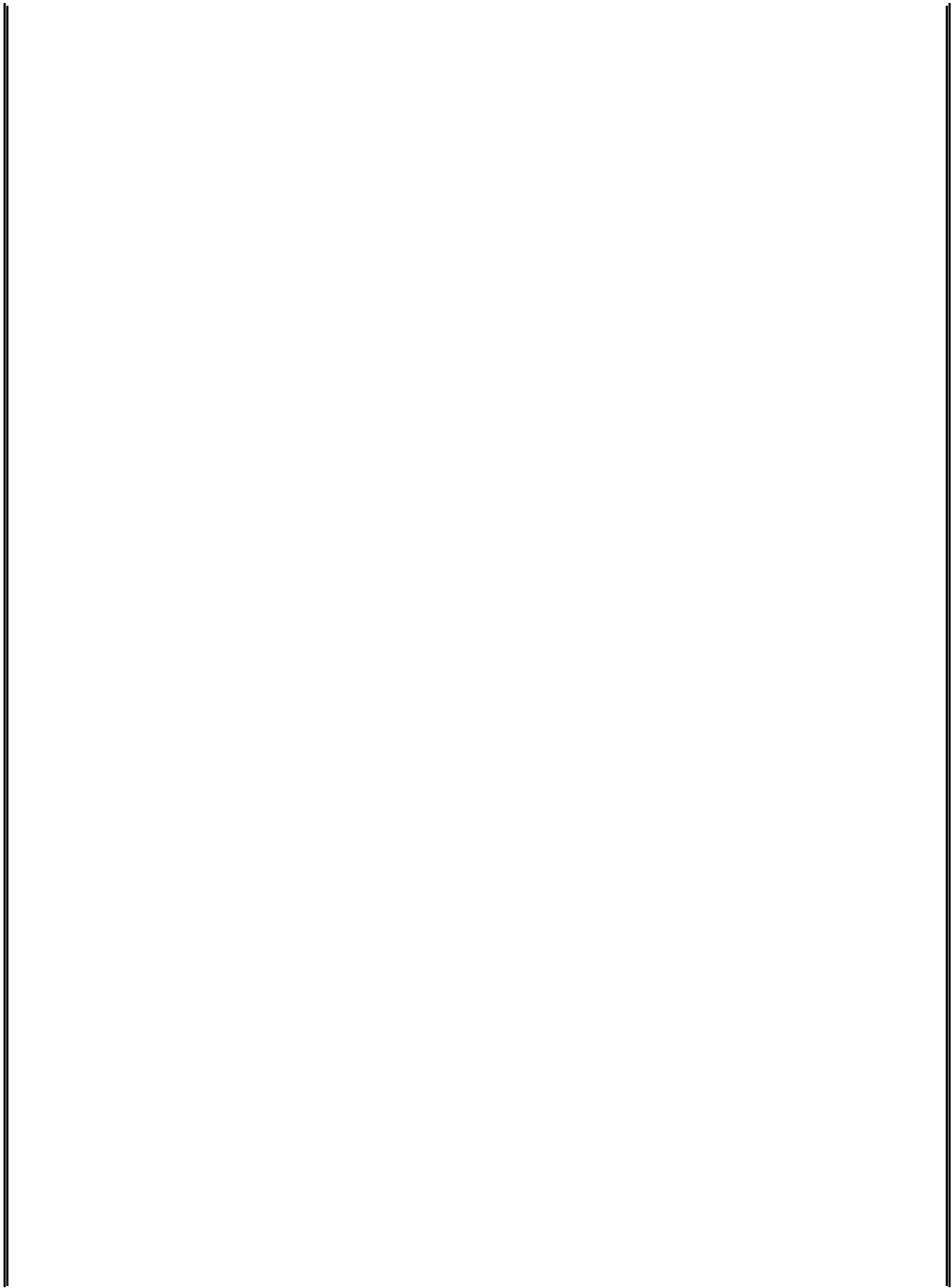

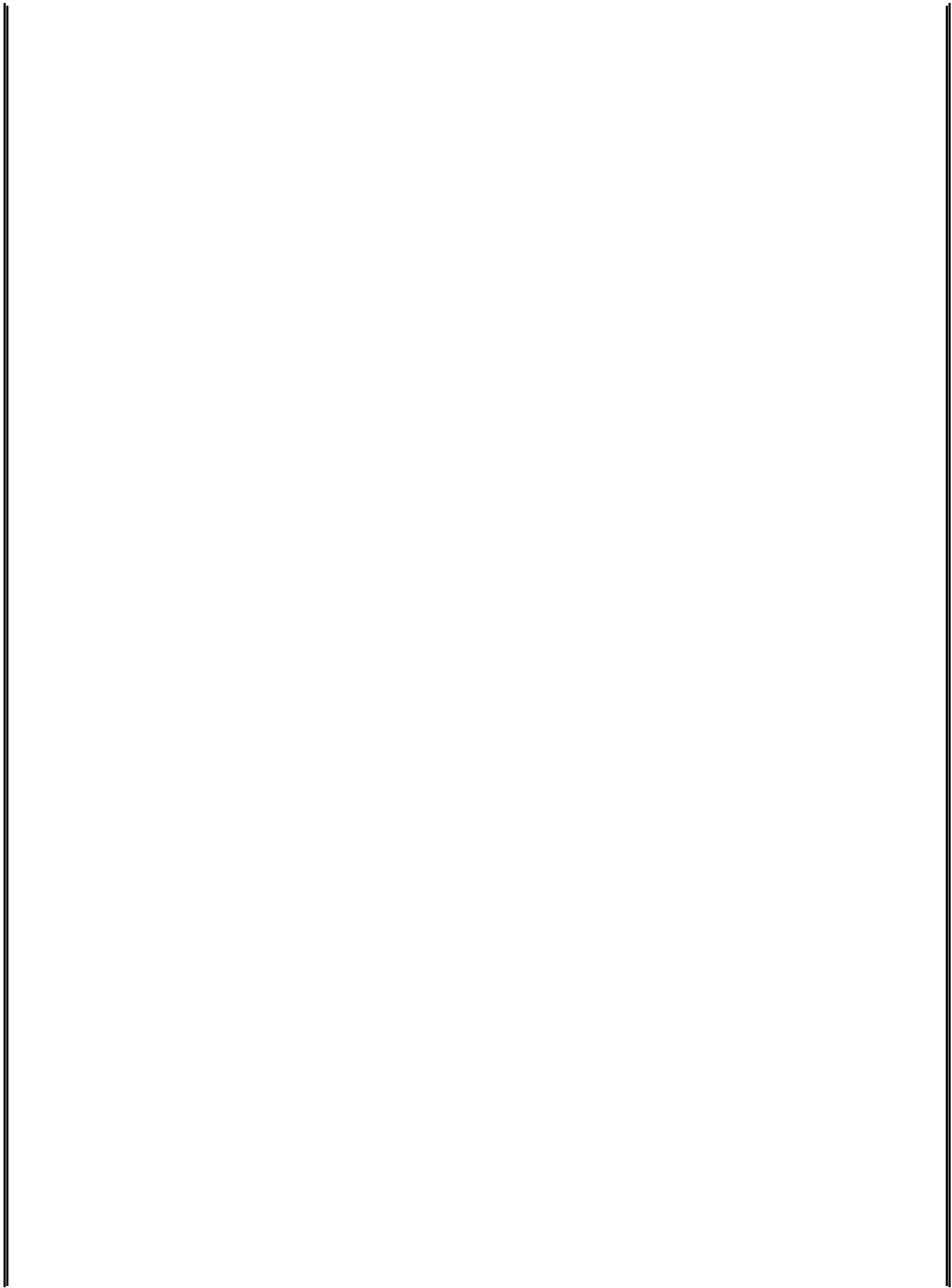

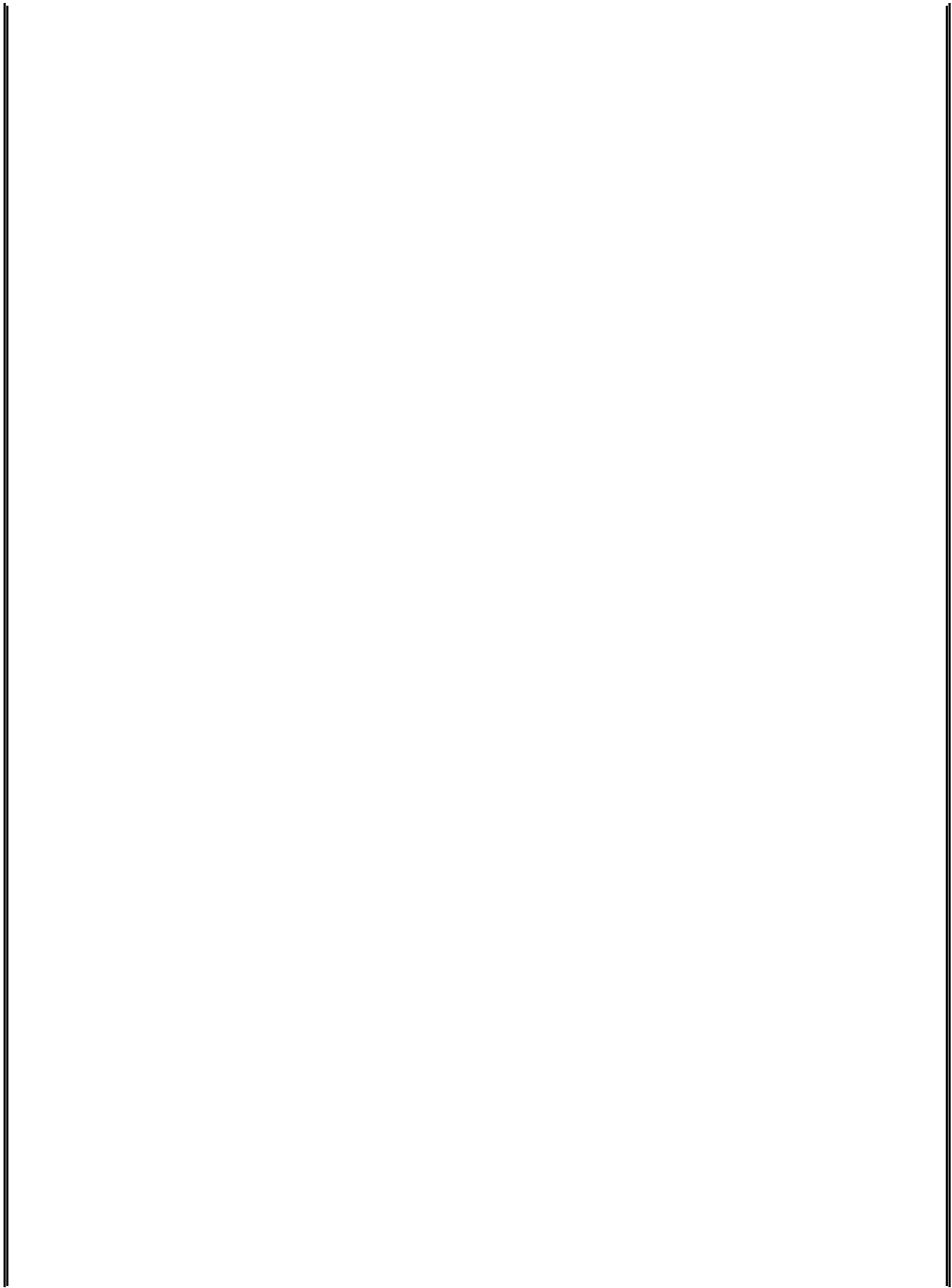

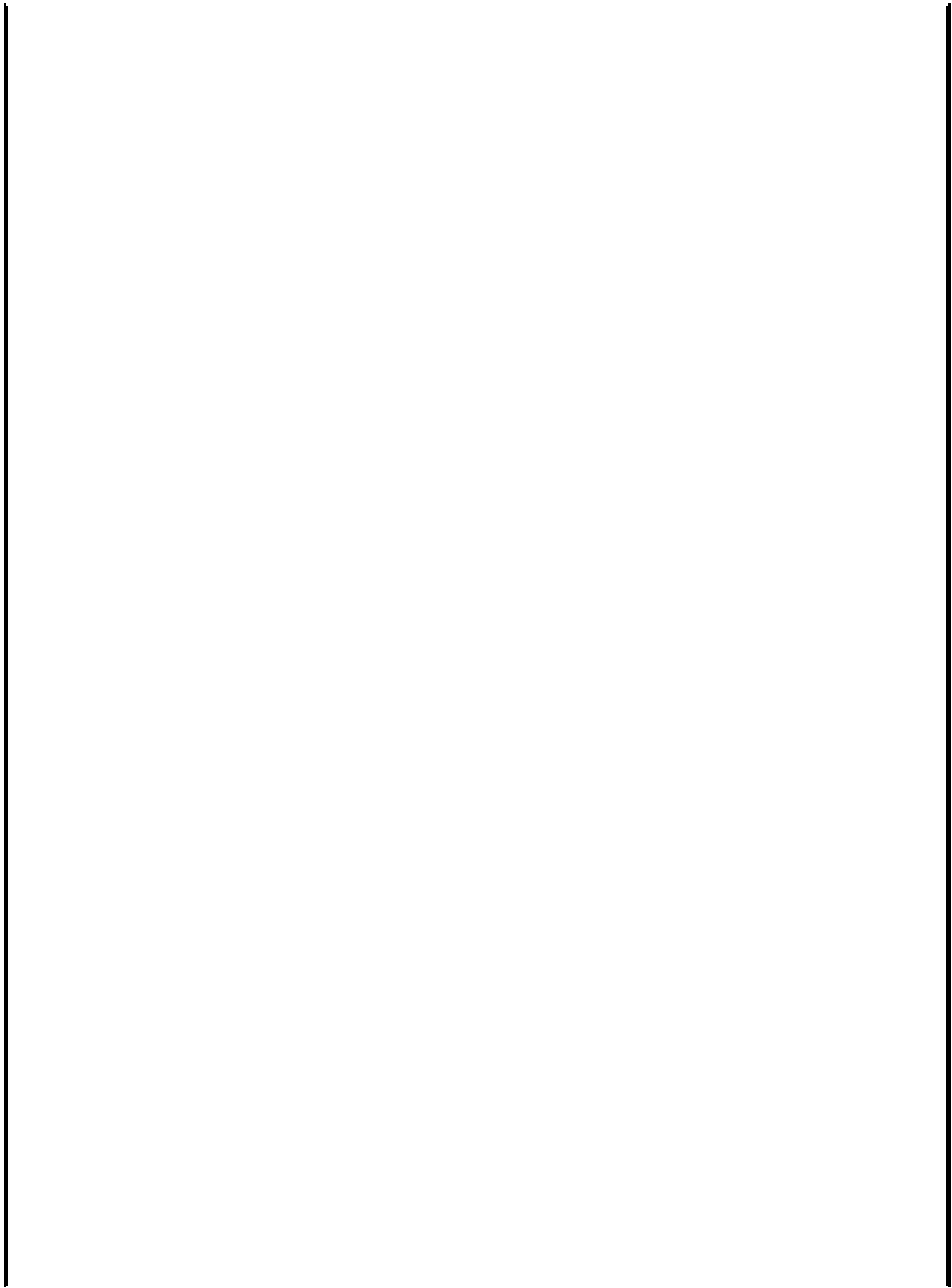

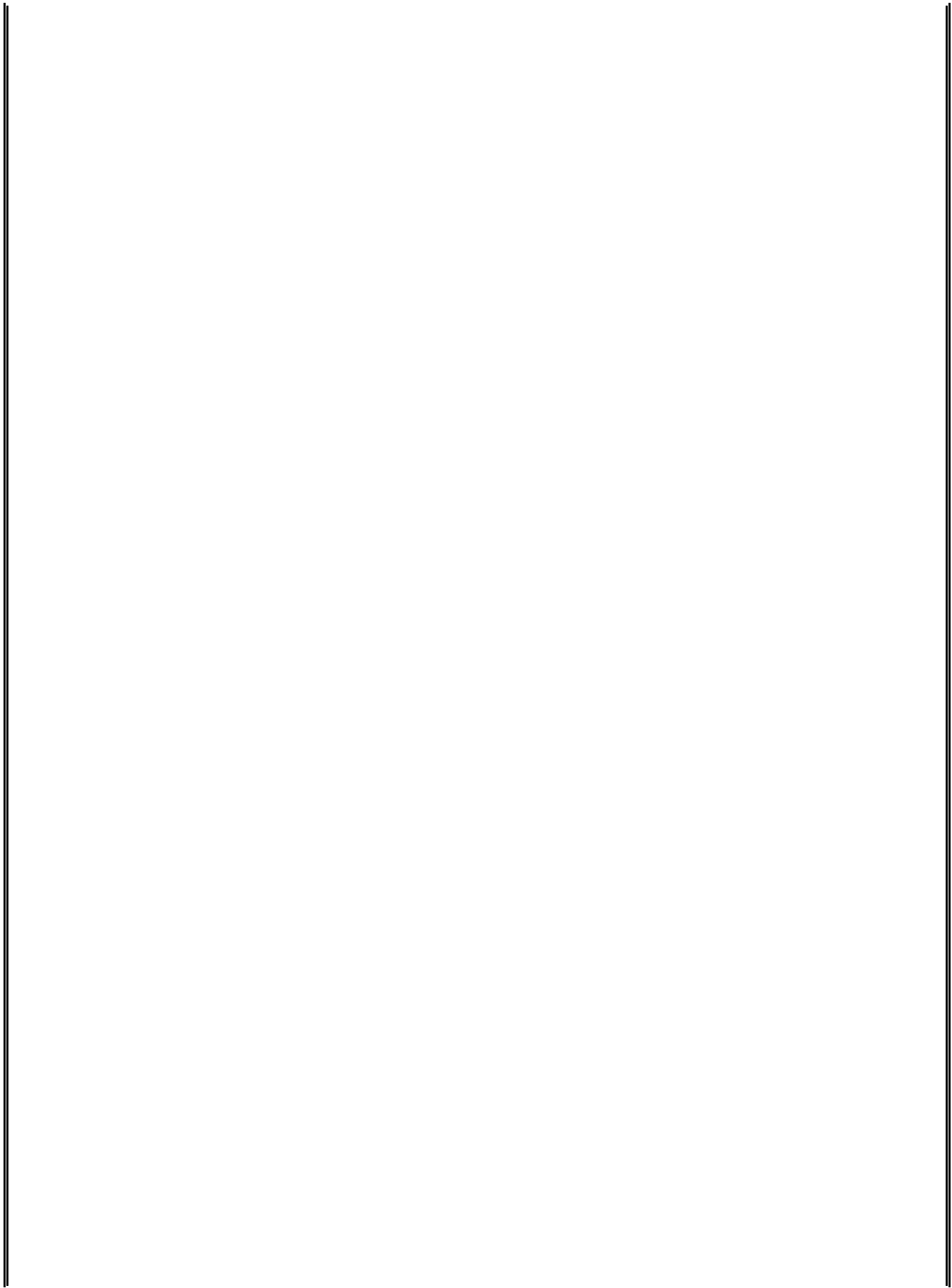

Species	2004	2005	2006	2007
Pied Bill Grebe			1	
Double Crested Cormorant				
Great Blue Heron	1	1		2
Canada Goose	214	130	192	122
Mute Swan	3	3	5	15
Wood Duck			4	
American Black Duck		12	13	12
Mallard	192	166	170	161
Black/Mallard hybrid		1		
American Wigeon				
Ring-necked Duck				
Greater Scaup				
Common Goldeneye				
Bufflehead			3	
Hooded Merganser	8	4	37	27
Red-breasted Merganser				
Common Merganser		6	27	4
Green-winged Teal				1
Ruddy Duck			19	
Turkey Vulture			4	
Northern Harrier				
Sharp-shinned Hawk	1	1	1*	4
Cooper's Hawk	1			6
Northern Goshawk				
Red-tailed Hawk	9	11	9	9
American Kestrel				
Peregrine Falcon				
Ring-necked Pheasant				
Wild Turkey				7
Virginia Rail				
American Coot		1	1	
Common Snipe				
American Woodcock				
Ring-billed Gull	89	81	116	22
Herring Gull	17	36	18	2
Great Black-backed Gull	2	1	4	
Rock Pigeon	21	36	31	20
Mourning Dove	100	89	108	98
Eastern Screech Owl	1	7	7	
Great Horned Owl		1		2
Barred Owl				
Belted Kingfisher	2	3	2	
Red-bellied Woodpecker	2	3	6	3
Yellow-bellied Sapsucker		1	1	2
Downy Woodpecker	34	39	43	47
Hairy Woodpecker	1	4	4	1
Northern Flicker	1	5	2	2
Blue Jay	17	71	87	60
American Crow	36	37	31	47
Fish Crow	27	20	6	

Birding Notes: Dovekie Lands in Newtonville

An exhausted dovekie, not usually found inland, did a belly flop in the backyard of Anne Simunovik (who has a feeder and keeps count of which birds come to her feeder). It was during the big snowstorm on Dec 16 (which caused the postponement of the Christmas Bird Count to the next weekend — the first time it has been changed due to weather). She did not know what it was, but found it in the Sibley bird guide — it kind of looks like a miniature penguin, and its wings are well suited to flying under water, where it feeds on small crustaceans, etc. Anne and her husband, Sergio, watched it that day and tried to feed it, even cutting up some salmon, etc. It was wary and ran away, but stayed overnight.

The next day, unfortunately, the bird died, exhausted and far away from its North Atlantic home. Anne kept the bird in a bag in her freezer, and it was of great interest to the birders assembled the next Sunday for the Christmas count, most of whom had never seen such a bird. Mass. Audubon was queried and put out the word. The tiny bird (about the size of a starling) will not have died in vain, as there was interest from the Harvard Museum of Natural History for its collection.



Eagle Has Not Landed! Alison Leary, one of our Christmas Counters, reported a Bald Eagle flying overhead early last week in the vicinity of the footbridge above the Watertown dam. She also reported a Ring-necked Duck in that same area in late January. The large flock of Mallards and Canada Geese sometimes contain a few uncommon ducks as well. With frozen ponds, the flowing waters of the Charles River have been good for birding!

Future Vision for Albemarle Road and Cheesecake Brook

A community meeting to discuss a vision for Albemarle Road and Cheesecake Brook was held on Thursday February 7th -- 7:00 PM at the Horace Mann School . The Massachusetts Water Resources Authority is planning a major construction project along Albemarle Road and North St, with construction to start in 2009. Newton's Department of

Public Works, the Friends of Albemarle, and other groups are working with MWRA to develop practical improvements that can be undertaken in coordination, along the Cheesecake Brook Corridor. These groups believe this area should provide bicycle and pedestrian paths, state-of-the-art environmental amenities, and expanded passive recreation opportunities.

At the meeting, the City's engineering consultant, Weston & Sampson, provided a PowerPoint presentation showing possible site alternatives. The Albemarle Road / Cheesecake Brook Greenway links residential Newtonville, the City's largest sports recreation complex - Albemarle Park, FA Day and Horace Mann Schools, and the Charles River pathway, connecting to Boston, Cambridge, Watertown and Waltham.

Funding for the design of Watertown St. to the Charles River has been provided through Newton's Community Preservation funds, and the engineering firm of Weston & Sampson has been hired for this project. The design and construction of the Greenway near Eddy Street has been completed (funded through CDBG). The planned redesign of the Albemarle entrance to F.A.Day Middle School has been placed on hold, pending clarification of funding opportunities.

For more information, contact Curtis Betts - 617 965 1799 or Margaret Albright - 617 969 0497 or email info@friendsofalbemarle.org. Information and discussion on this project is available online at groups.yahoo.com/group/FriendsofAlbemarle (registration may be required to view design documents and photographs)

Notes from the Newton Angino Community Farm

We pass on the following information gleaned from the Newton Angino Community Farm newsletter.

Spring is just around the corner and now is the time to think about luscious tomatoes, crisp lettuce, and crunchy carrots. We invite you to contribute to the financial viability of Newton's community farm by pre-purchasing a CSA share. Enrollment begins February 11th for Newton residents (February 25th for non residents) and is first-come, first-served. CSA participants receive tender and delicious vegetables we grow – salad makings, tomatoes, greens, peas, beans, summer squash and more -- throughout the 20-week CSA season: June 11th to late October. Certain items such as potatoes and winter squash, which require more space than our modest site allows, are purchased from partner farms. CSA members share in the bounty of the farm, and also the work and the risk. We have confidence that we will meet our production goals, but growing vegetables always involves a certain amount of uncertainty.

A regular share costs \$525 and is sized to provide sufficient produce for a family of four. Starting June 11th, shareholders come to the farm once a week to pick up vegetables. The CSA season lasts about 20 weeks, ending approximately October 23rd. Shares include many PYO (pick-your-own) items – including beans, cherry tomatoes, herbs, and peas. Some people find regular shares too large, so we offer the option of an Alternate Week Share at a cost of \$275. Participants pick up produce every other week throughout the season, beginning either June 11th

or June 18th. Alternate Week Shareholders are assigned an alternate-week schedule on a first-come, first-served basis; half the Alternate Week Shares will be assigned to each week. All CSA participants have a work commitment, as a way to support the farm operation, foster education, and develop a sense of community and identification with the farm. For Regular Sharers the work commitment is at least 12 hours. For Alternate Week Sharers it is at least 6 hours. Please consider working your hours early.

Regular shareholders pick up their produce weekly. Alternate Week shareholders pick up every other week. Produce pick-up days are either Wednesdays or Thursdays from 3-7 PM. Come each week the day that works best for you. If you cannot come, feel free to have a friend pick up your share. If you don't have time for the PYO options during the week you are welcome to pick between 10-3 on Saturdays. To purchase a CSA share please fill out the Enrollment Form and mail it back with your check made out to Newton Community Farm, Inc. Enrollment forms can be found on our website or by using the following link:

<http://www.newtoncommunityfarm.org/CSA2008%20Enrollment%20Form.pdf>.

Please join us in our third year. Buying a CSA share is only one way to support the farm. You can also buy food at our on-site farm stand, at the Tuesday Cold Spring or Friday California Street farmer's markets, work on one of our volunteer teams, or make a tax-deductible donation. Our mission is to teach and model sustainable agriculture, provide locally and sustainably grown produce, and preserve the beauty and historical significance of the Newton Angino Community Farm. Newton Community Farm, Inc. donates 10% of the produce grown for the CSA to the Newton Food Pantry. Your tax-deductible contributions support this and all other farm activities.

For more information, please contact the Farm Manager, Greg Maslowe, at newtoncommunityfarm@comcast.net or (617) 797-1611 or visit the website at <http://www.newtoncommunityfarm.org/>.

Green Decade Notes

We provide some information from the Green Decade Coalition. If you are interested in membership in the Green Decade, you can join for as little as \$25 for an individual/family membership and \$50 for a business membership. There is also have a new Student membership at \$10 for the year! Join or renew on-line at www.greendecade.org or download the membership form and mail with your check made out to GDC/N, to PO Box 590242, Newton, MA 02466. Membership forms are also available in each issue of the Green News (pickup at the Library). For more information, contact 617-965-1995 or e-mail membership@greendecade.org.

Watch for a very special lecture on **March 24** featuring **Frances Moore Lappe** who will be speaking on her two books "**Diet for a Small Planet**" and "**Getting a Grip**". These two books focus on "understanding the interconnections between our food supply system and the range of environmental, economic and political problems facing us"; and how we, as individuals and collectively, can work toward constructive solutions to them".

The 2008 Newton Student Art and Essay Contests on Conserving Energy

Last year the Green Decade Coalition/Newton implemented an exciting Newton Student Energy Conservation Essay Contest that encouraged students to reflect and speak out in a creative way towards global warming and energy conservation. Mayor David B. Cohen announced the 2008 Student Energy Conservation contest on February 2, which includes the essay contest plus an *art contest* so that students can have new ways to express their feelings and ideas about this important issue affecting us all. Newton energy consumption continues to climb in spite of increased awareness of the harm caused by CO2 emissions and global warming. The Green Decade Coalition/Newton and the Mayor's advisory committees on Renewable Resources and Sustainability envision that the essay and art contests and the related publicity will encourage people to reduce their energy consumption.

The contests are open to all students who live or go to school in Newton, grades K-12. Students may enter the essay contest, the art contest or both contests, and the submission deadline is March 15, 2008. Entries will be judged by school level and additional details are available at www.greendecade.org/energycontestinfo.html. Prizes for the contest are sponsored by NSTAR, the Newton Schools Foundation and other organizations, and will be awarded for 1st, 2nd and 3rd place winners plus 4 distinction prizes for each contest. Submission deadline is March 15, 2008 and the announcement of Winners will take place on April 22, 2008. Judging will be by current and former Newton teachers. For additional information on entering the contests and registration, plus contest details, contact the Green Decade at 617-965-1995 or energycontest@greendecade.org. We hope to see all Newton students participate in this year's contests!

Newton History Museum Notes

Visit the Newton History Museum online at <http://www.ci.newton.ma.us/jackson/>. Watch for the upcoming exhibit in April about Norumbega!

Thursday, February 28, 7 pm

DISCOVERIES IN SCIENCE: THE NEWTON EXPERIENCE

As part of the Newton History Series, cosponsored by the Newton History Museum and the Newton Free Library, Dr. Rainer Weiss, Professor Emeritis of Physics at MIT, will discuss scientific evidence that supports the explosive origin of the universe: The Big Bang Theory. His talk will include such topics as how distances in the universe have been determined, the recession of galaxies, and the discovery and measurement of heat from the primal explosion. Dr. Weiss, a long-time Newton resident, received the Einstein Prize of the American Physical Society in 2007. Free. At the Newton Free Library, 300 Homer Street, Newton. For more information, contact the Newton Free Library at 617-796-1360.

26th Annual Newton House Tour - Sunday, May 18, 2008

Save the day for the Boston area's premier house tour. Visit homes throughout Newton, which showcase excellence in architecture and design.

NewtonSERVES - Sunday, April 13, 2008

NewtonSERVES is a day in April when over 1000 volunteers throughout the city join together to work at over 50 project sites, helping to beautify schools, non-profit organizations, and parks. For more information on the event in general, visit the event website at <http://www.ci.newton.ma.us/newtonserves/> or contact Beverly Droz, Volunteer coordinator for Newton, (617-796-1290, bdroz@newtonma.gov).

New Off Leash Ordinance Passed - Volunteers Needed!

What does this mean? A NEW ORDINANCE that makes it legal for residents to let their dogs off-leash in designated public spaces as part of a two year pilot program was recently passed by the Newton Board of Aldermen. The full text of the ordinance can be found at http://www.ci.newton.ma.us/Legal/Ordinance/Chapter_3_web_version_Revisions_12-21.pdf in **Sec. 3-30 Dogs Off-Leash Pilot Program**.

BEFORE any off-leash areas can be designated, an off-leash advisory committee responsible for reviewing possible areas must be appointed.

CITIZEN GROUPS interested in having a specific area designated for off-leash activity must present the committee with a proposal. Off-leash areas may be areas dedicated solely for off-leash activity, or they may be shared spaces where dogs may be off-leash only during certain hours, days, or seasons.

What can you do to help?

- * Volunteer as a potential member of the Advisory Committee.
- * Identify a location, in your neighborhood, where a dogs off-leash program could be created.
- * Form a resident group to advocate for one or more locations in your neighborhood or the city at-large.

For more information please contact Alderman Susan Albright at 617-796-1715 or salbright@newtonma.gov.

You can use the following form to indicate interest:

I would like to be a volunteer to work with the Advisory Committee

I recommend the following location be considered as an off-leash

I would like to form a neighborhood group and recommend the following location(s) be considered

Name : _____
 Address: _____
 Phone: _____
 Email: _____

Please return to: Alderman Susan Albright, Newton City Hall, 1000 Commonwealth Avenue, Newton, MA, 02459
 or email information to salbright@newtonma.gov.

MISSION - Newton Conservators, Inc.

The Newton Conservators promotes the protection and preservation of natural areas, including parks, playgrounds, forests and streams, which are open or may be converted to open space for the enjoyment and benefit of the people of Newton. It further aims to disseminate information about these and other environmental matters.

A primary goal is to foster the acquisition of land, buildings and other facilities to be used for the encouragement of scientific, educational, recreational, literary and other public pursuits that will promote good citizenship and the general welfare of the people of our community.

The Newton Conservators was formed as a not-for-profit organization 47 years ago in June 1961.

Newton Conservators Membership Form

PO Box 590011, Newton Centre, MA 02459 • www.newtonconservators.org

Celebrating 47 years of open space advocacy in Newton

YES, I'd like to start/renew my one-year membership with the Newton Conservators to help preserve open space in Newton. I'll receive informative newsletters and emails and be invited to participate in guided tours of local conservation areas, lectures, and other programs and activities.

I'd like to make an additional tax-deductible contribution to support the work of the Newton Conservators: \$ _____

Please do not share my name and address with other groups.

MEMBERSHIP OPTIONS

- Individual member \$25
- Family member \$35
- Sustaining member \$50
- Donor \$75
- Patron \$100

All amounts are tax deductible

NAME _____

STREET _____

VILLAGE _____ **ZIP** _____

EMAIL ADDRESS _____

Make checks payable to **Newton Conservators, Inc.**

**Please renew today.
And consider a tax-deductible gift to support our work!**

The year's hottest artists on the red carpet at the Grammy Awards. [AOL Music takes you there.](#)